

LIGHTHOUSE 250 LANTERN & USB POWER HUB

Get to Know Your Gear

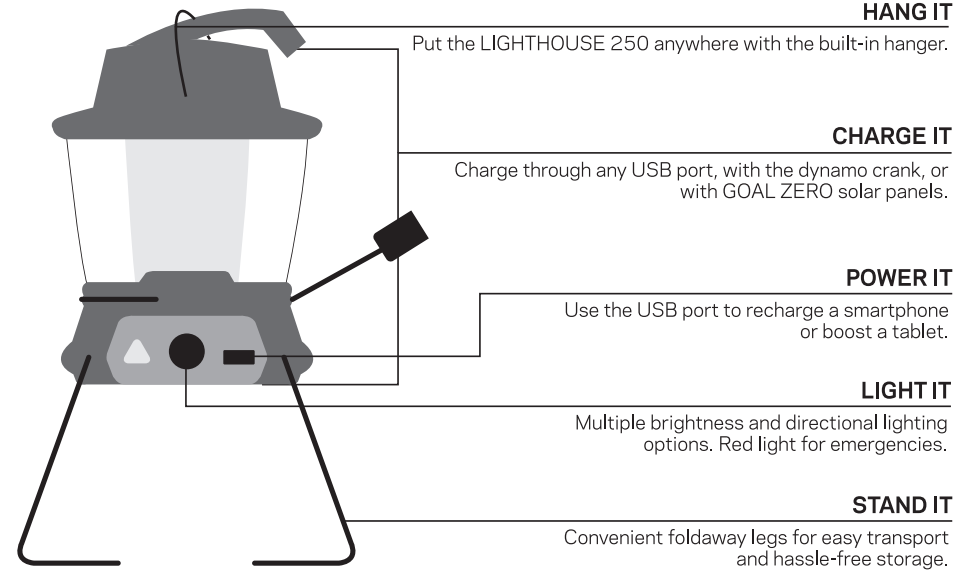

Getting Started

1. Be sure to **ACTIVATE YOUR WARRANTY** at www.GOALZERO.com/warranty
2. Charge up the LIGHTHOUSE 250 through any USB port. Compatible with NOMAD Solar Panels.

How to Use Your Gear

- 1 USB Rechargeable Light**
Power up the LIGHTHOUSE 250 from any USB port with the built-in cord. Blue LED lights indicate battery level.
- 2 Dynamo Crank**
Recharge by dynamo crank function: flip the crank handle up from the top of the lantern and rotate. One minute of cranking will provide approximately ten minutes of light on low power.
- 3 DUALITE™ Directional Lighting**
Turn the knob right or left for different directional lighting and brightness options.
- 4 Emergency Light**
Push the triangle button for red, emergency alert mode.
- 5 Power Your Gear**
Recharge smartphones, and boost tablets through the USB port.

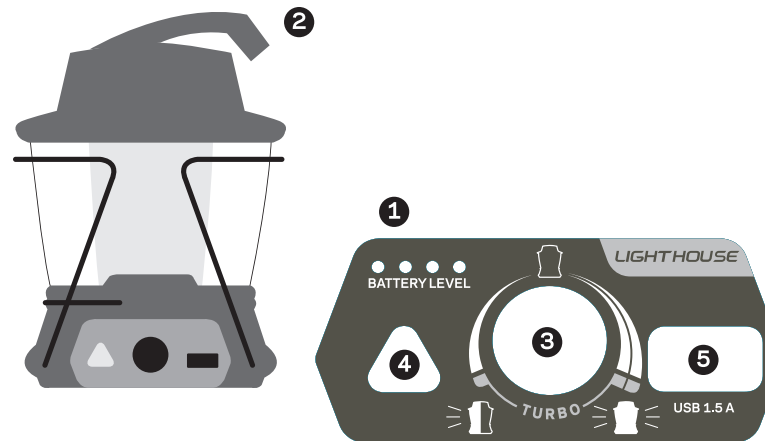

Technical Specs

Recharge Times

NOMAD 7 Solar Panel: 7-14 Hrs

USB: 7 Hrs

Run Times

Half-light (low power): 48 Hrs

Full-light (low power): 24 Hrs

Half-light (high power): 12 Hrs

Full-light (high power): 6 Hrs

Half-light (turbo power): 5 Hrs

Full-light (turbo power): 2.5 Hrs

Inputs

USB port: 5V, up to 1A (5W)

Hand crank: 2.2W (cranking at 120 RPM)

Outputs

Light: 2x3W, warm white CREE LED, 250 lumens

USB port: 5V, up to 1.5A (7.5W), regulated

Battery

Cell type: Li-NMC

Cell capacity: 16Wh (3.7V, 4400mAh)

Shelf life: charge every 3-6 months

Management system: Built-in charging and low-battery protection.

General

Weight: 1.1lb (498g)

Dimensions: 4.5 x 5 x 6.5in (11.4 x 12.7 x 16.5cm)

Warranty: 12 months

Operating temp: 32-104F (0-40C)

Certification: CE, FCC, ROHS

Frequently Asked Questions

How often do I need to charge the LIGHTHOUSE 250?

It is recommended to charge your LIGHTHOUSE 250 lantern every 3 months. The blue LED lights indicate the current battery level.

Does it matter what direction I turn the hand crank?

Nope. You can turn the hand crank in either direction for power. Remember, 1 minute of crank time equals about 10 minutes of light on low.

Compatible With

GOAL ZERO products:

NOMAD Solar Panels

GOAL ZERO SWITCH 8 Recharger

GUIDE 10 Plus Recharger

SHERPA Rechargers

GOAL ZERO YETI Solar Generators

Any USB port

USER GUIDE

LIGHTHOUSE 250 LANTERN & USB POWER HUB

- Fill out your warranty
- Watch demo video
- Download this manual



CONTACT US:

Toll Free: 888.794.6250

675 W 14600 S
Bluffdale, UT, 84065

WWW.GOALZERO.COM

We proudly support Tifie Humanitarian

WWW.TIFIE.ORG